

DRAWING NAME: \\BKF-S\vol14\2025\0884\_S\_De\_Anza\_Townhomes\_(Dividend)\_Planning\Sheets\C3.0\_SDAT-SITEPLAN.dwg  
PLOT DATE: 09-04-25 PLOTTED BY: rskr

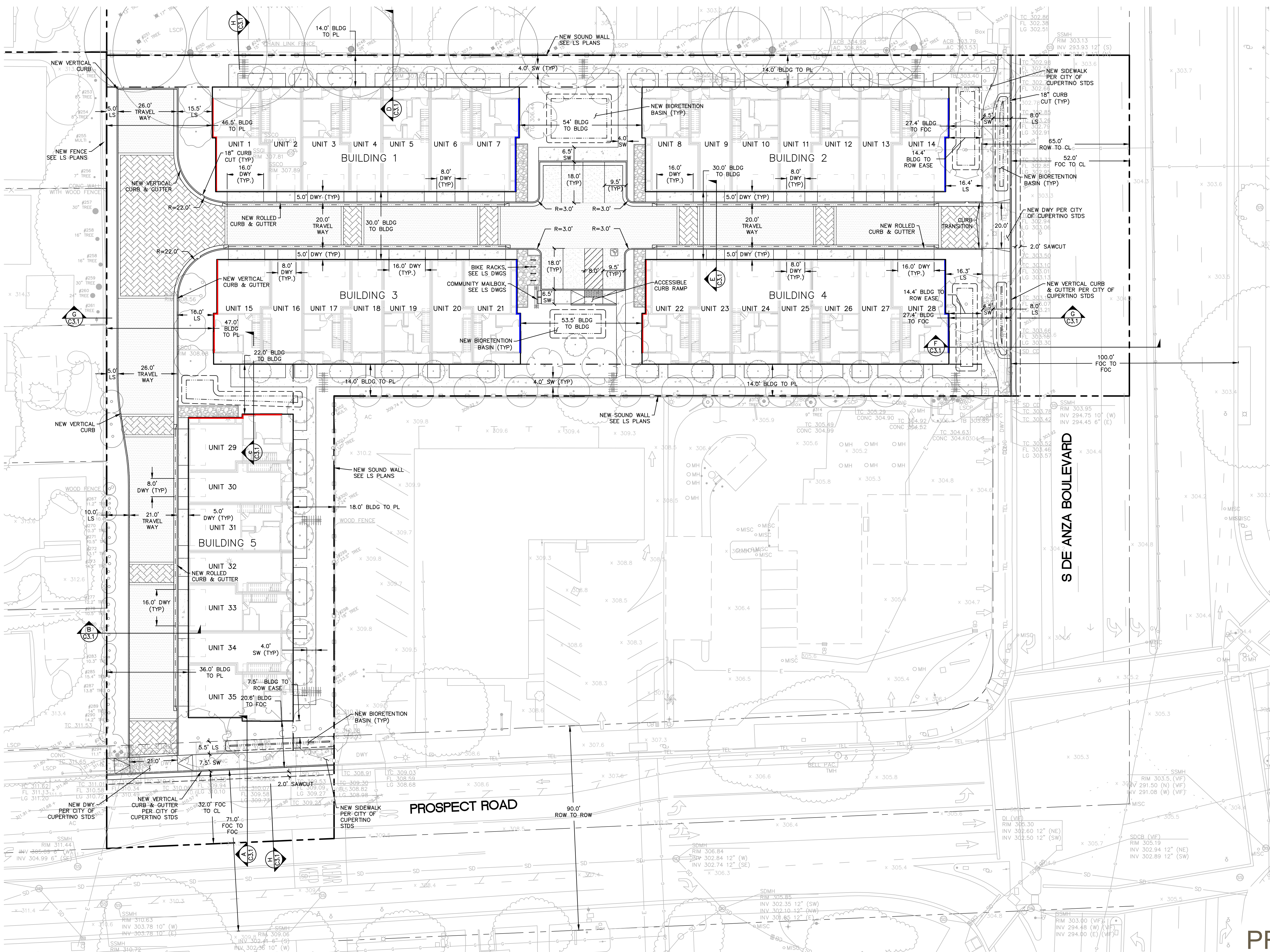

## LEGEND

SUBJECT PROPERTY LINE	---
ADJACENT PROPERTY LINE	---
CENTERLINE	---
SAW-CUT LINE	---
BIORETENTION BASIN	[Symbol]
VERTICAL CURB	---
VERTICAL CURB & GUTTER	---
ROLLED CURB & GUTTER	---
NEW AC	[Symbol]
NEW CONCRETE	[Symbol]
PERVIOUS PAVEMENT	[Symbol]
STAMPED CONCRETE	[Symbol]
DECOMPOSED GRANITE (DG)	[Symbol]
DEEPEENED FOOTING	[Symbol]
STEM WALL	[Symbol]
NEW FENCE	[Symbol]
NEW SOUND WALL	[Symbol]
NEW PERGOLA (SEE LS PLANS FOR DETAILS)	[Symbol]

## GENERAL NOTES

1. REFER TO LANDSCAPE PLANS FOR ALL HARDSCAPE FINISHING DETAILS.

## PRELIMINARY SITE PLAN

### 1655 S De Anza Boulevard CUPERTINO, CA DIVIDEND HOMES

DAHLIN GROUP ARCHITECTURE | PLANNING | INTERIORS

WWW.DAHLINGROUP.COM



HSW



DATE 09-01-2025  
JOB NO. 20250884  
1730 N FIRST STREET, SUITE 600  
San Jose, CA 95112  
408-467-9100

C3.0